

# COLD FRONT



## Cooling Media Replacement

TO REDUCE THE RISK OF FIRE, ELECTRICAL SHOCK, OR INJURY TO PERSONS, OBSERVE THE FOLLOWING:

**⚠ WARNING: ELECTRICAL SHOCK HAZARD.** Disconnect the power supply before performing any service or maintenance. Failure to do so may result in serious injury or death.

**⚠ CAUTION:** The Big Ass Fans product warranty will not cover equipment damage or failure that is caused by improper installation or use.

### COLD FRONT 200

#### 1. Remove screens and old pads

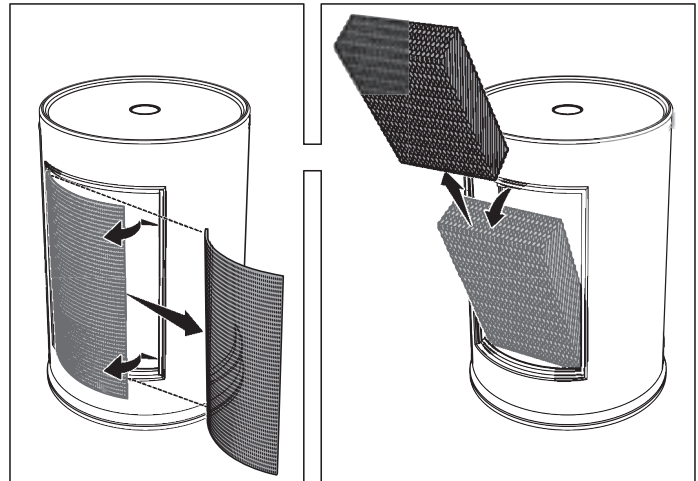
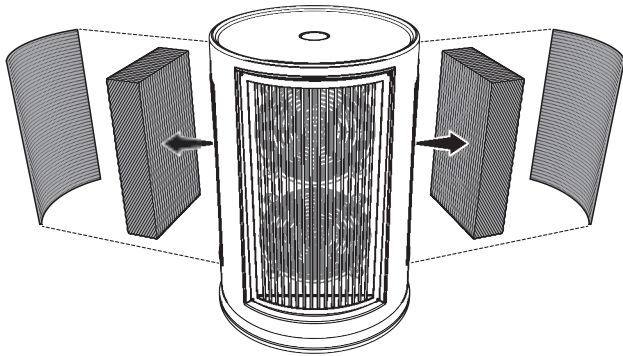

#### 2. Orient and install new pads, reinstall screens

Dimensions: 12 in. x 4 in. x 21 in. (305 mm x 102 mm x 533 mm)

Quantity: 2

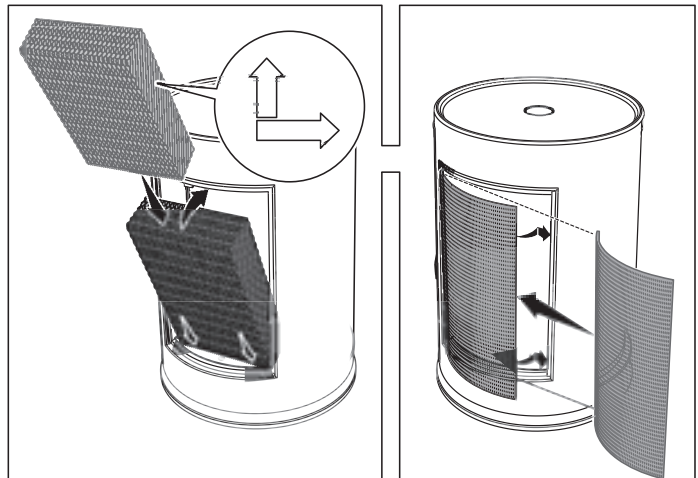
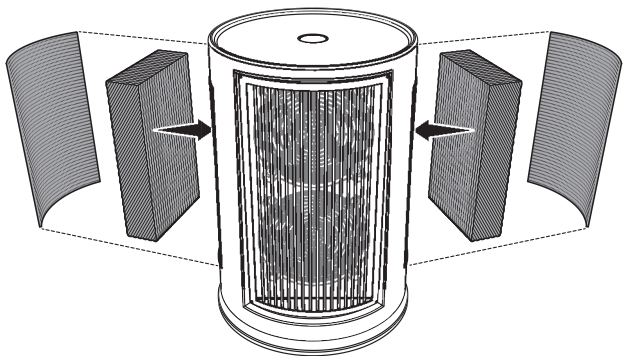

## COLD FRONT 300

### 1. Remove retainer bar

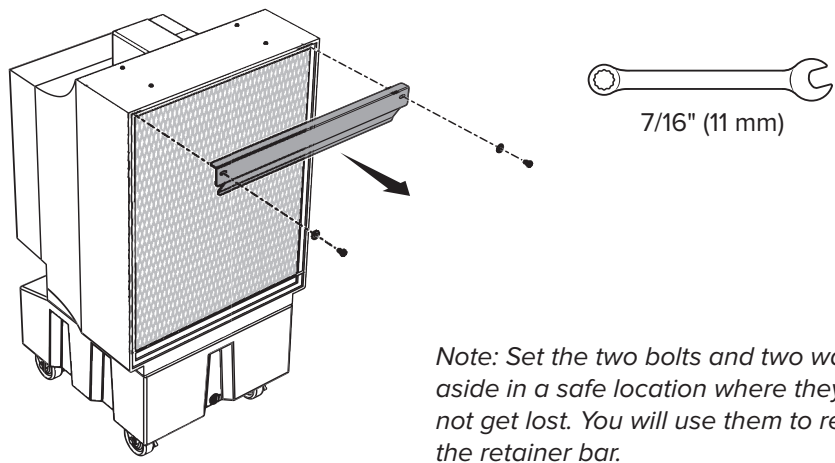

### 2. Remove center pad

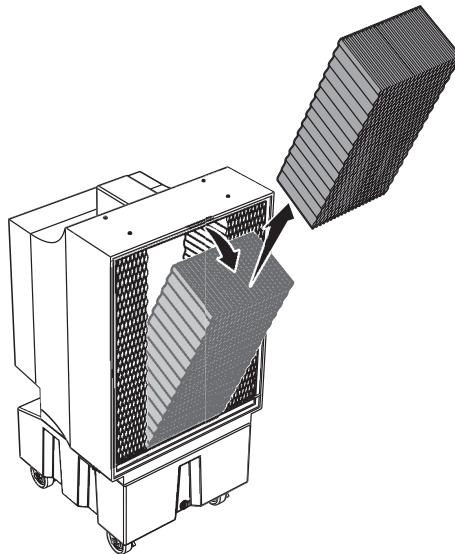

### 3. Remove side pads

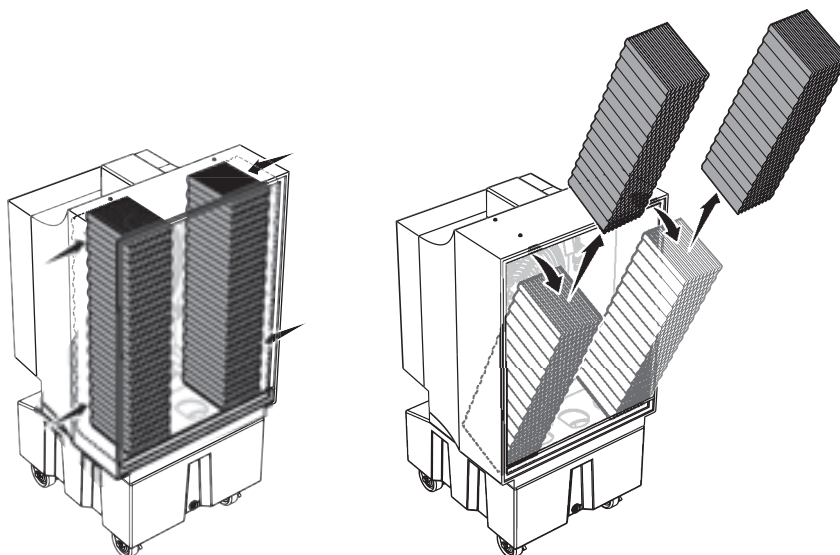

## COLD FRONT 300 (CONT.)

### 4. Orient and install new side pads

Dimensions: 6 in. x 8 in. x 29 in. (152 mm x 203 mm x 737 mm)

Quantity: 2

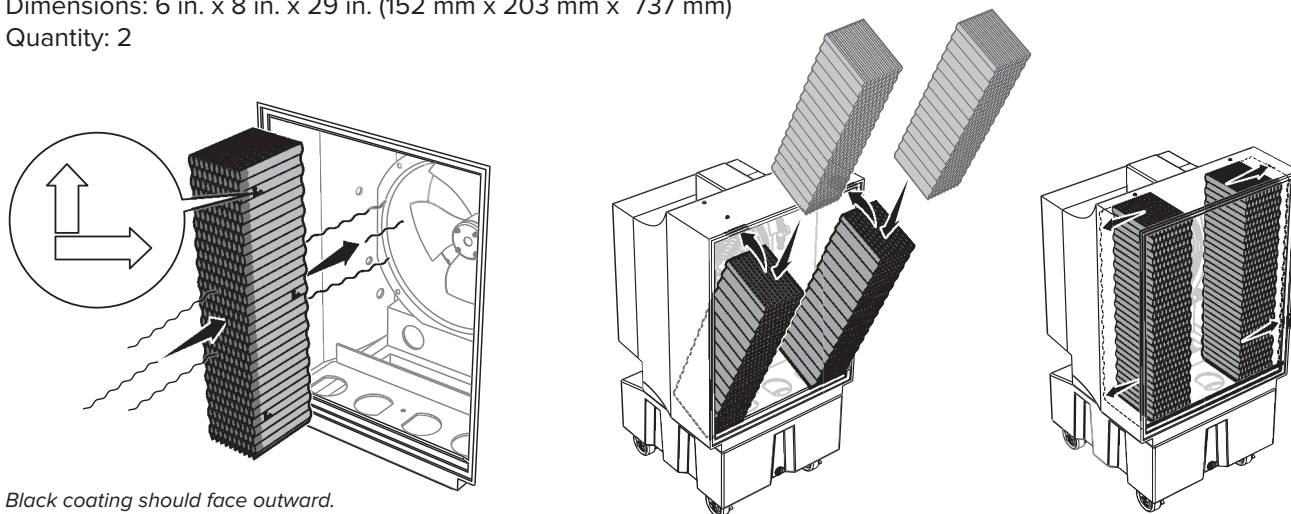

*Black coating should face outward.*

### 5. Orient and install new center pad

Dimensions: 12 in. x 8 in. x 29 in. (305 mm x 203 mm x 737 mm)

Quantity: 1

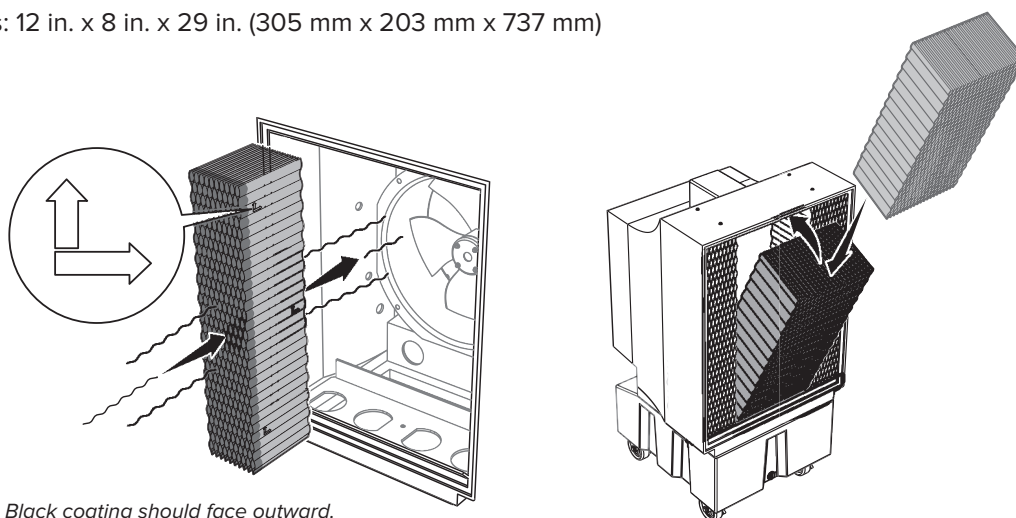

*Black coating should face outward.*

### 6. Reinstall retainer bar

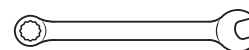
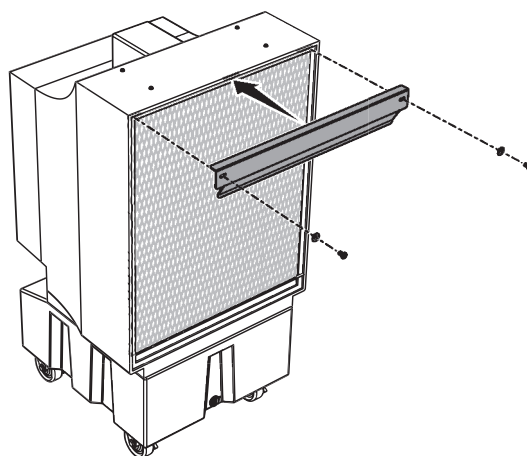

7/16" (11 mm)

**Do not overtighten  
bolts.**

## COLD FRONT 400/500

### 1. Remove retainer bar

Cold Front 400 (two bolts)

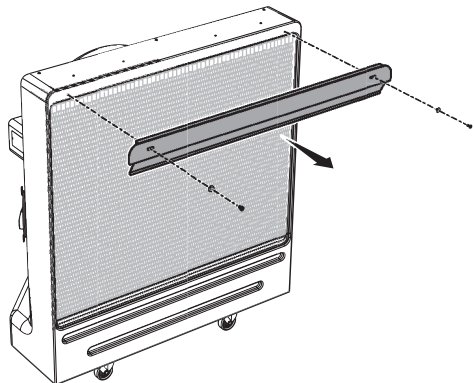

Cold Front 500 (four bolts)

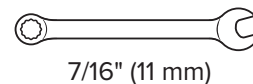
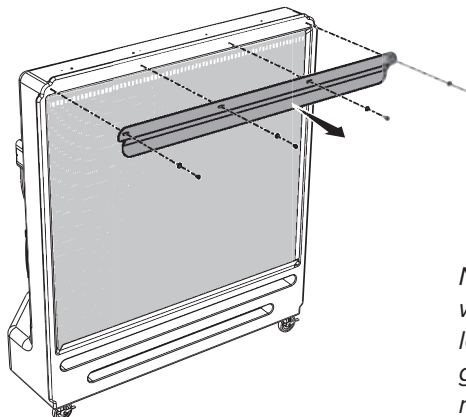

*Note: Set the bolts and washers aside in a safe location where they will not get lost. You will use them to reinstall the retainer bar.*

### 2. Remove top pads

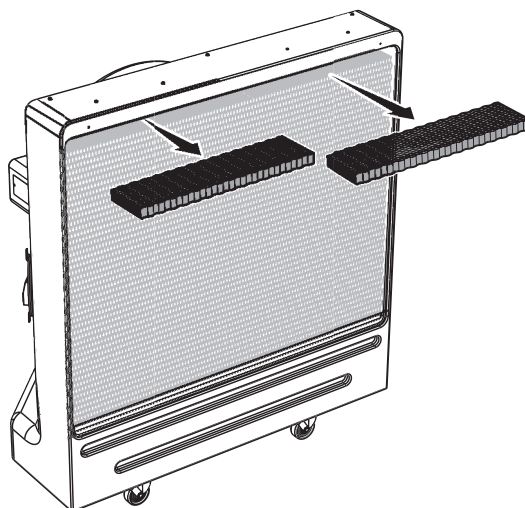

### 3. Remove center pads

Cold Front 400: Three center pads

Cold Front 500: Four center pads

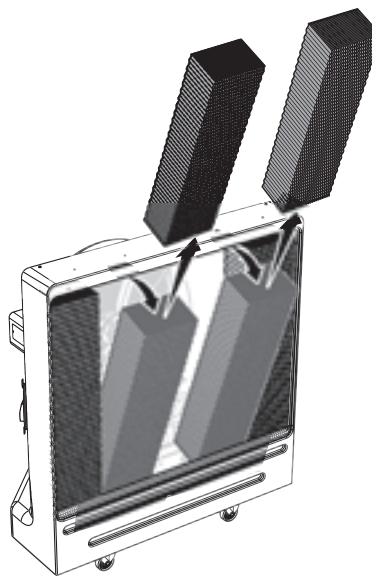
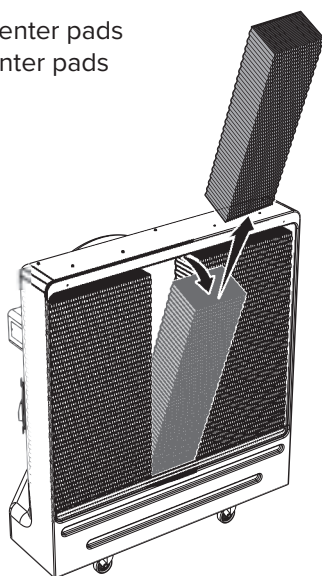



## COLD FRONT 400/500 (CONT.)

### 4. Remove side pads

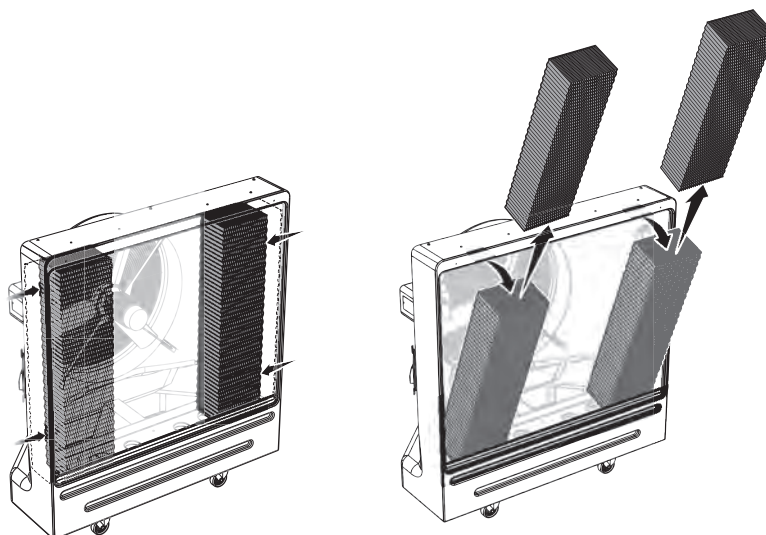

### 5. Orient and install new side pads

Cold Front 400: 12 in. x 8 in. x 48 in. (305 mm x 203 mm x 1219 mm) Quantity: 2

Cold Front 500: 12 in. x 8 in. x 60 in. (305 mm x 203 mm x 1524 mm) Quantity: 2

*Note: Side pads and center pads are the same size.*

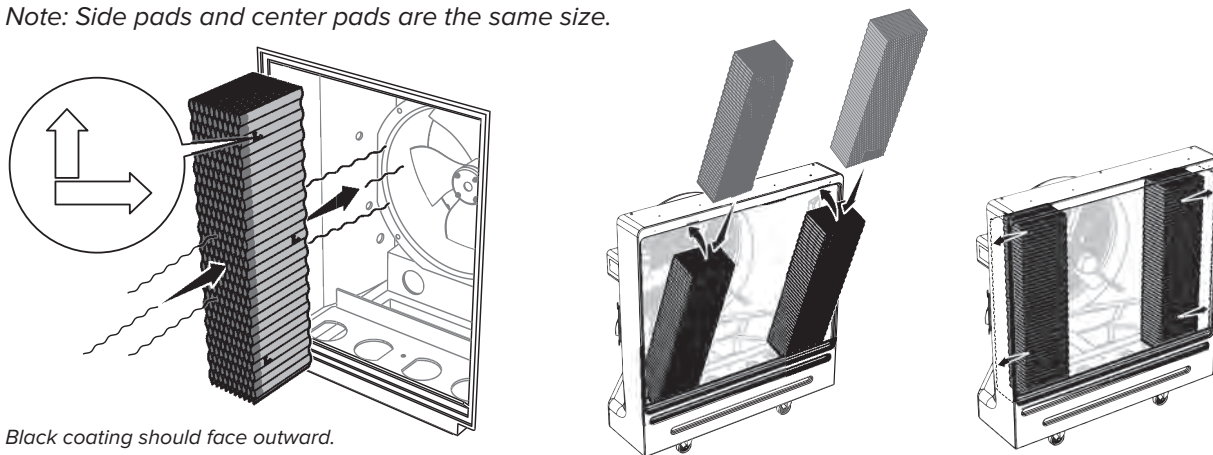

*Black coating should face outward.*

### 6. Orient and install new center pads

Cold Front 400: 12 in. x 8 in. x 48 in. (305 mm x 203 mm x 1219 mm) Quantity: 3

Cold Front 500: 12 in. x 8 in. x 60 in. (305 mm x 203 mm x 1524 mm) Quantity: 4

*Note: Side pads and center pads are the same size.*

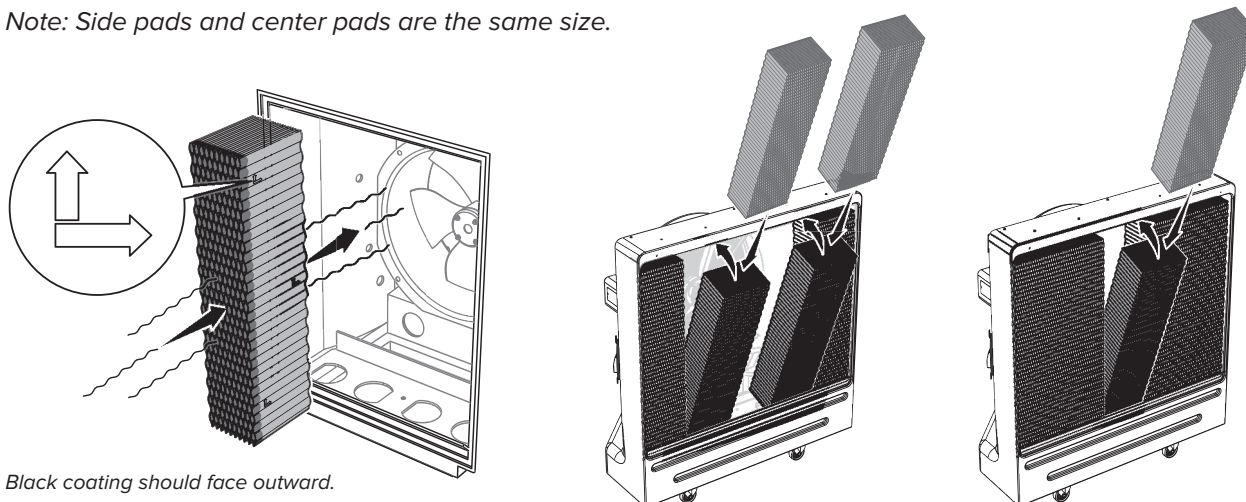

*Black coating should face outward.*

## COLD FRONT 400/500 (CONT.)

### 7. Install new top pads

Cold Front 400: 30 in. x 8 in. x 1.5 in. (762 mm x 203 mm x 38 mm) Quantity: 2

Cold Front 500: 36 in. x 8 in. x 1.5 in. (914 mm x 203 mm x 38 mm) Quantity: 2

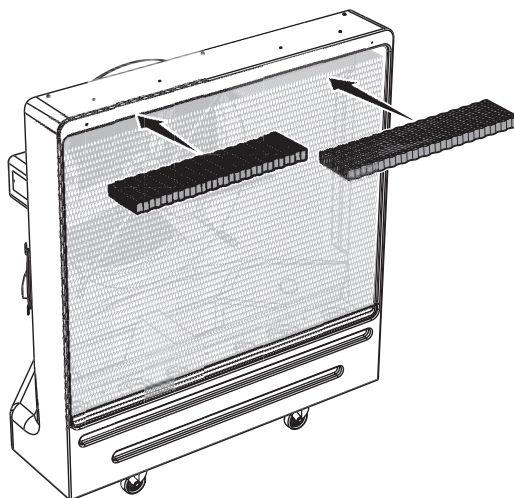

### 8. Reinstall retainer bar

Cold Front 400 (two bolts)

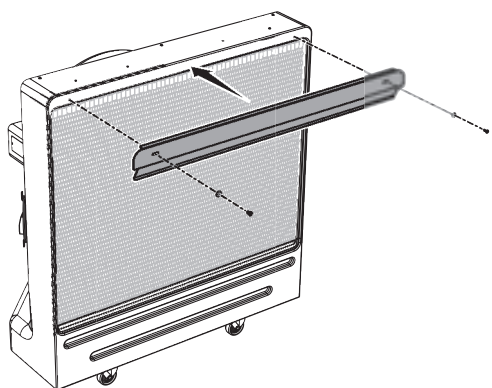

Cold Front 500 (four bolts)

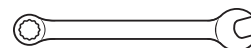
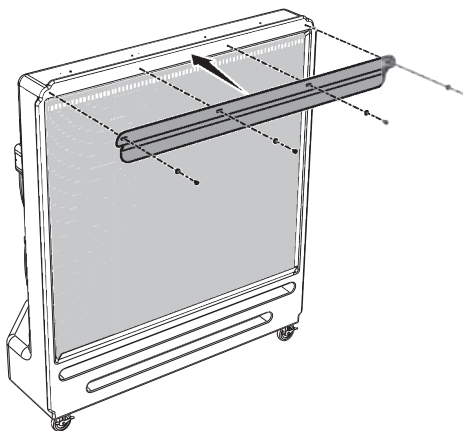

7/16" (11 mm)

**Do not overtighten  
bolts.**